

Adjacency and Space Planning



Education That Works



Out – Renewable Energy/Custodial Office
In – Vacant

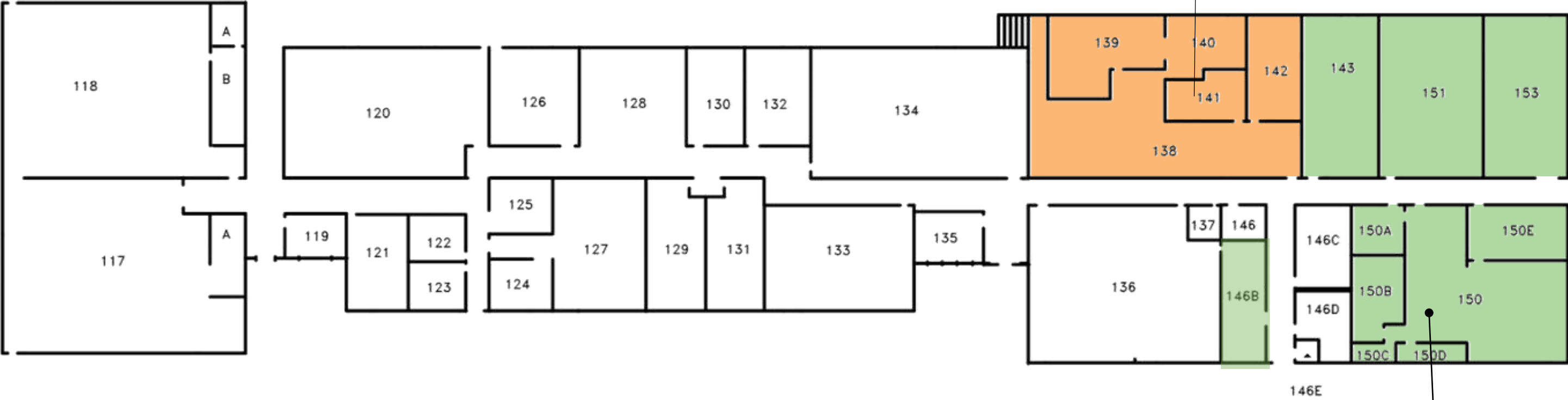

Out- Education and Human Services
In - Center for Business and Industry

 Vacant  Occupied



Workforce Development Services

Option #1 - Move to Streeter/with CTEC

Option #2 Move to Pauling B/with CTEC

Option #3 Remain

Reassigned - WDS within FRC
In - Education and Human Services

 Vacant  Occupied

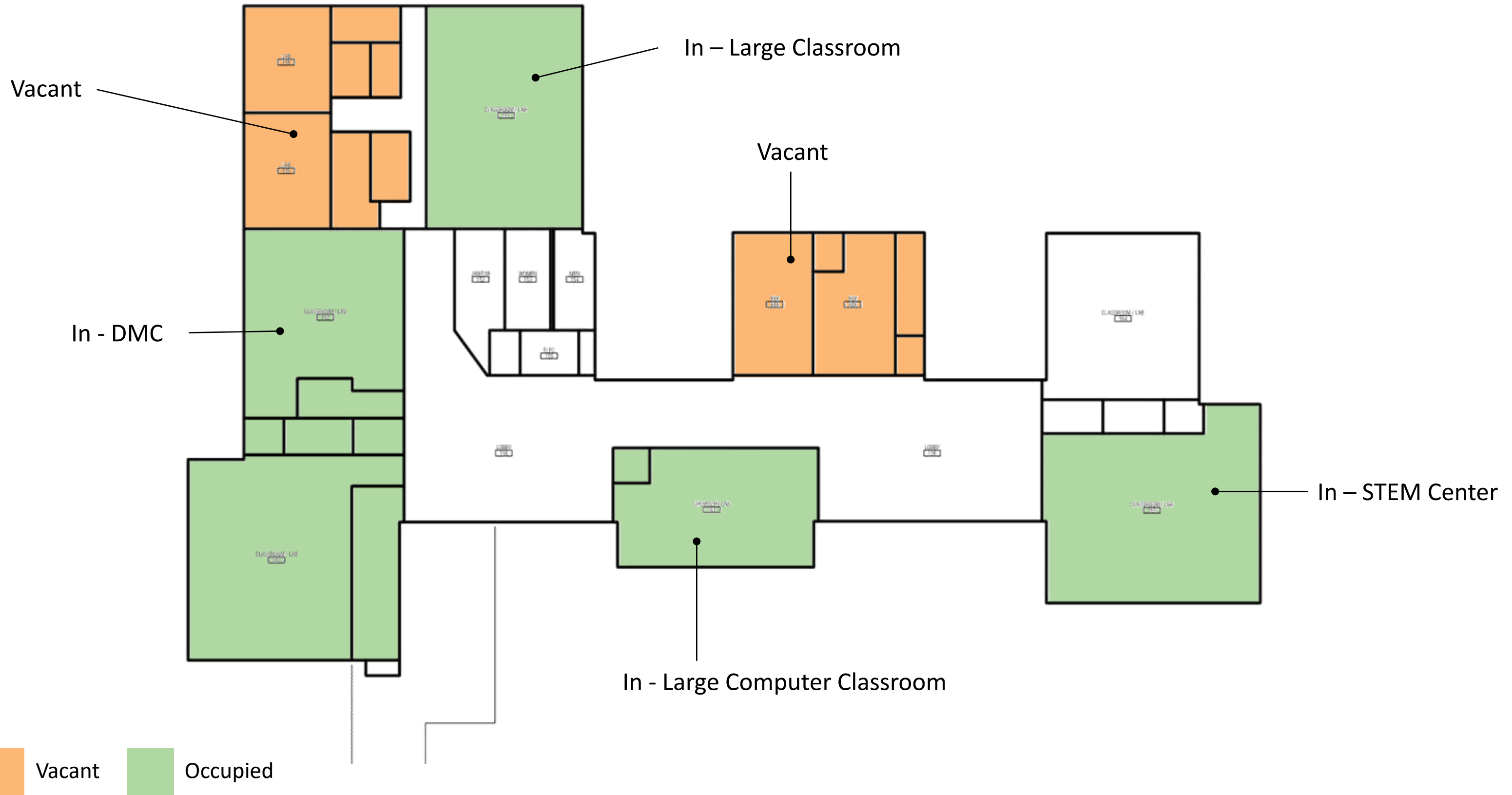

In – Small Computer Classroom



 Vacant  Occupied

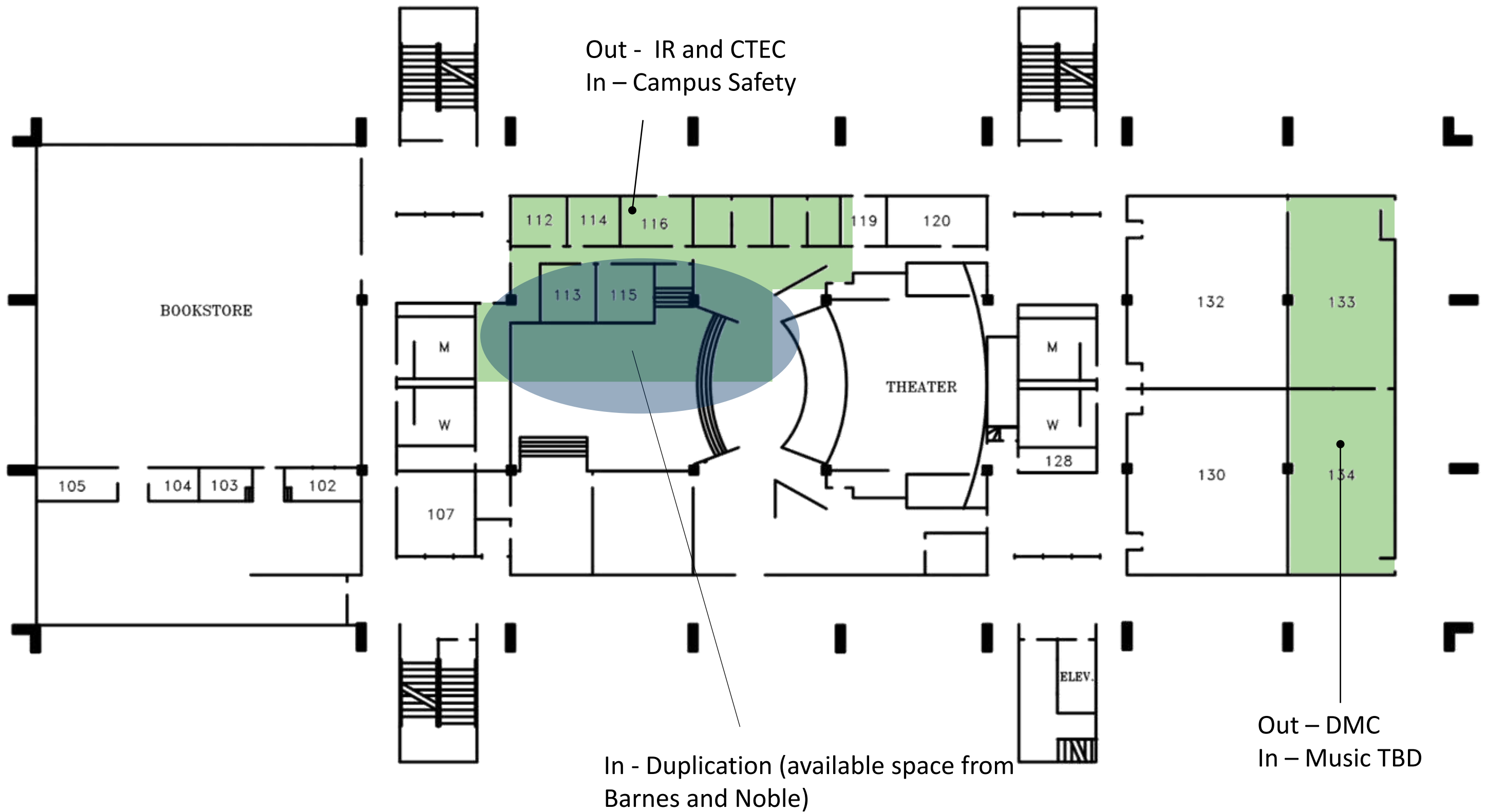

Vacant
 Occupied

Out – Business Department

In – Option #1 CTEC/WDS

In – Option #2 Select IEP staff



 Vacant  Occupied

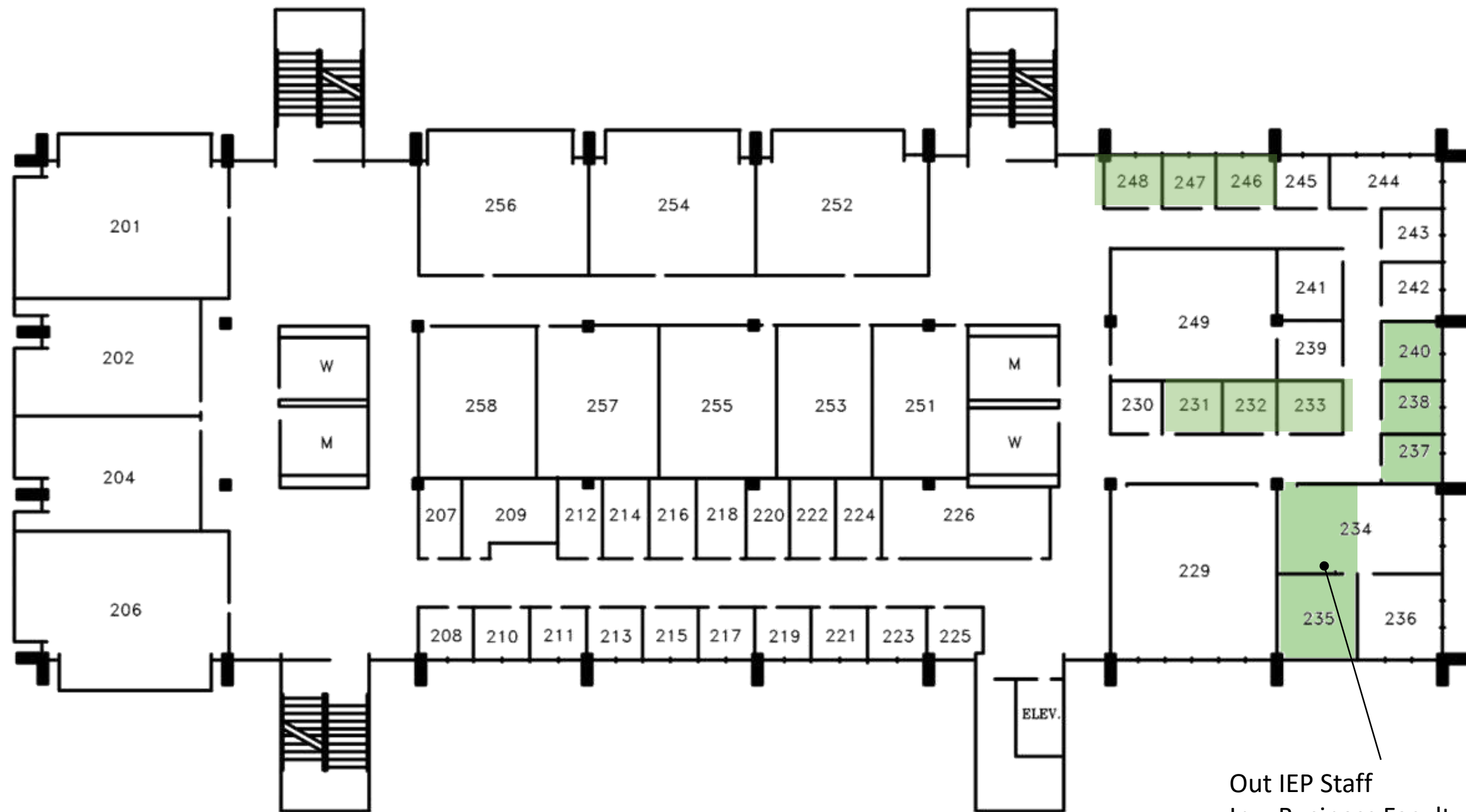

Out IEP Staff
 In – Business Faculty and support

 Vacant  Occupied

Out – Manufacturing
In- IT Administration

Out – Campus Safety
In – Association Office +?

Out – AFAC
Administration
In - Foundation

 Vacant  Occupied



Out – IT
Administration

Out - Foundation



 Vacant  Occupied

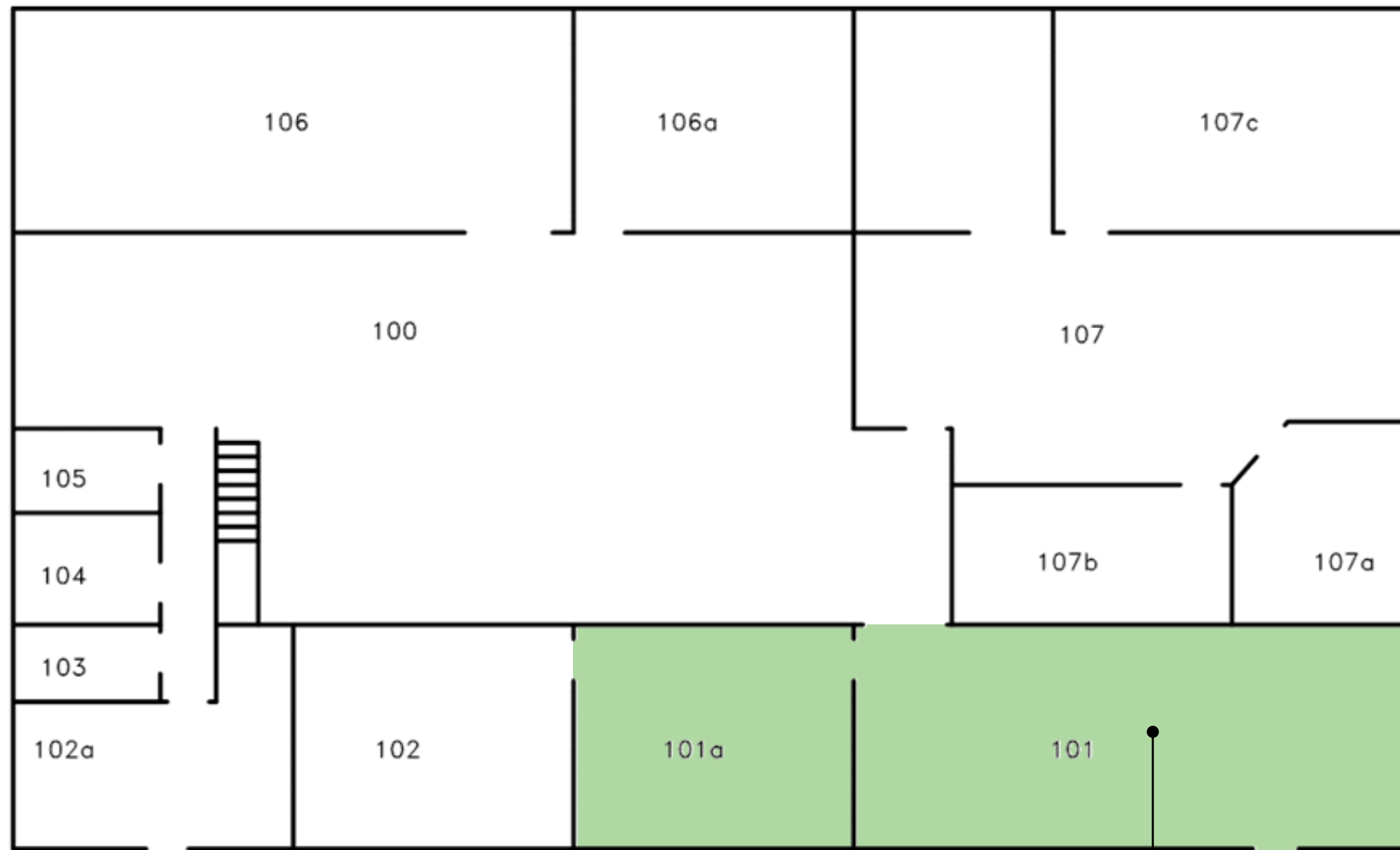

Vacant
 Occupied

Other spaces – not assigned but under consideration

- Training Center B - 150 Welding needs additional classroom space, looking at Backflow Lab
- Training Center A
 - Wildland Fire – needs 6 PT hotels
 - Apprenticeship – needs 3 PT and 1 FT classified office space
- Roger Rook
- Streeter Computer Lab (center)



Clackamas
Community College